

BOLENDER HORSE PARK

CLASS:

CHAMPIONSHIP IN-HAND

For:

Mini/Pony & Open In-Hand

1. Back "L"
2. Rolling Bridge, 360° turn
3. Pond, Back in, turn, walk to log, side pass out
4. Jump up, Down Wall
5. Trench
6. Water Box
7. Steps, 270° turn
8. Cross Bucks
9. Balance Beam

Mini/Pony: enter from side
270° turn

10. 45° Balance Beam
11. Trot
12. Rocks, choose your path
13. Logs
14. Swinging Bridge, walk on, turn, back off
15. Step down, Mud Bog

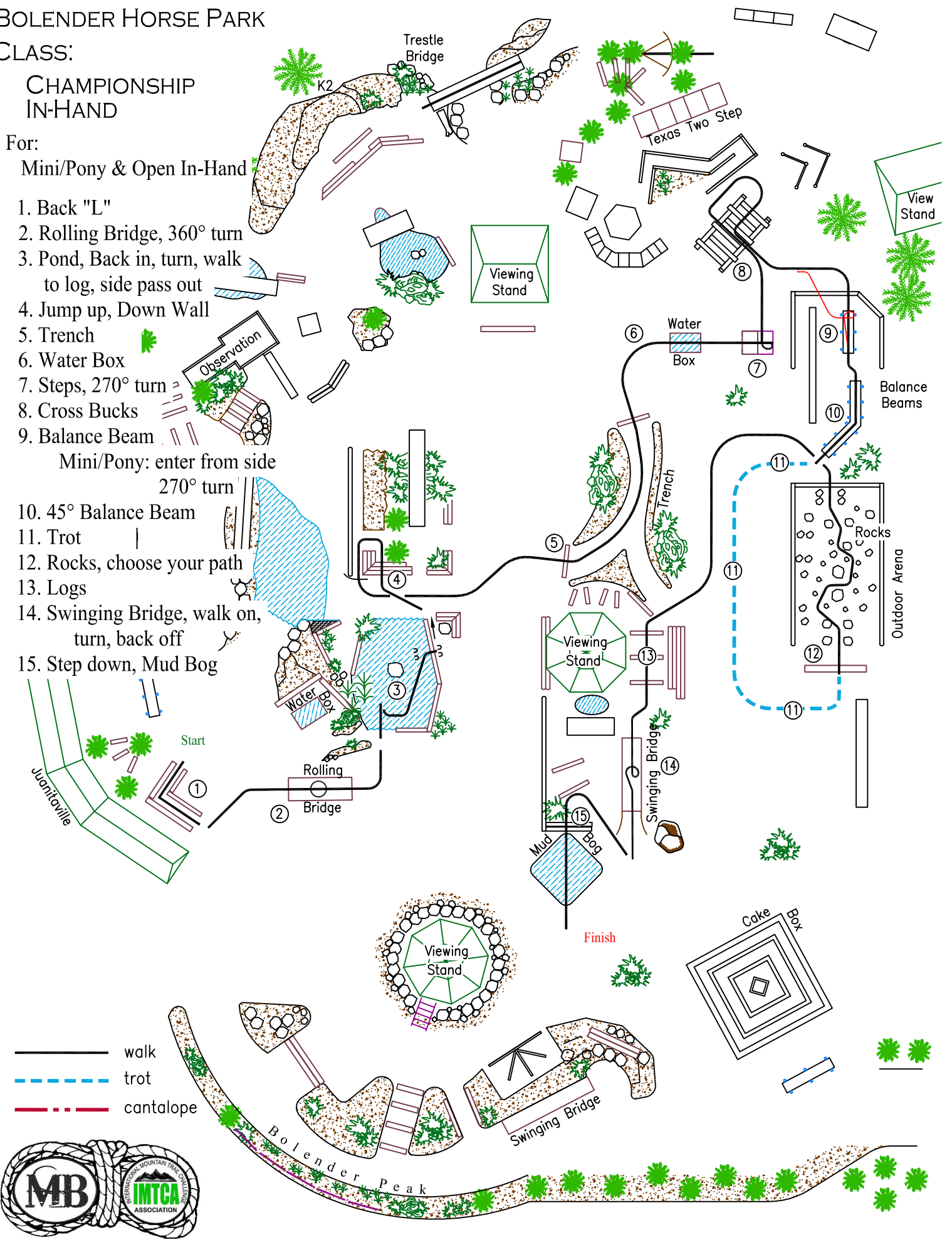

- walk
- - - trot
- . - cantalope

