

BOLENDER HORSE PARK

Class: 13 Youth Riding Lvl 2
19 Adult Riding Lvl 2

Revised

PATTERN: 7

CLASS: 13, 19

1. Box, Stand with loose rein
3 seconds
2. Trot, Balance Beam
3. Trot
4. Box, 360° turn
5. Step Down
6. Arch Bridge
7. Step Down
8. Logs
9. Side Pass, as shown
10. Trot, Water Box, 180° turn
11. Walk into "L" half way
Back out, turn to face judge, dismount

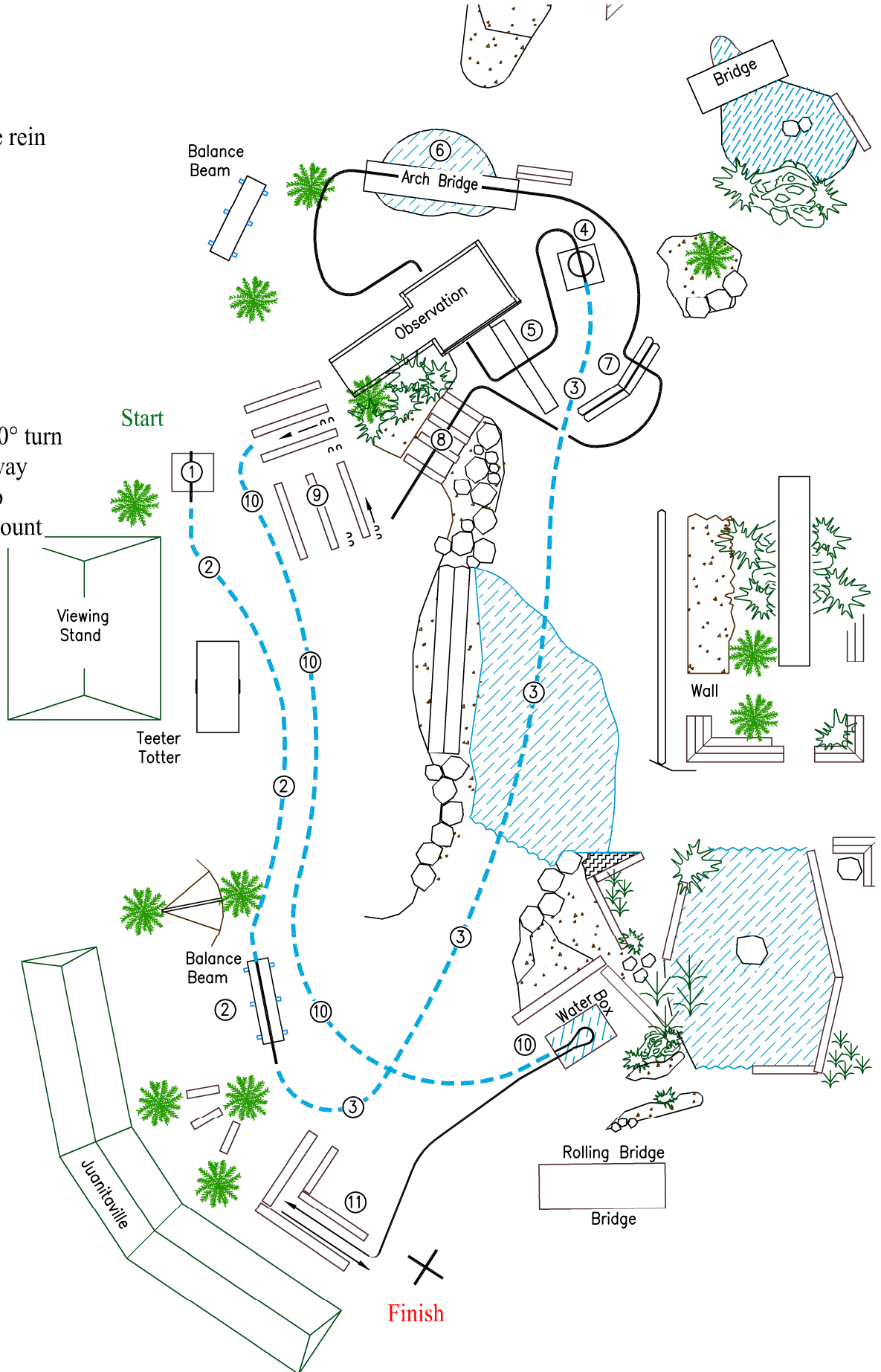

— walk
- - - trot
- . - cantalope

