

BOLENDER HORSE PARK

Class: 6 Mini/Pony In-Hand Lvl 3

PATTERN: 7

CLASS: 6

1. Swinging Bridge, turn and back off at center
2. Cake Box, send mini/pony to 2nd level, handler off cake box
3. Pond, step out, step in
4. Down Log Wall
5. Small Bridge
6. Logs
7. Send around rocks
8. Logs
9. Long Bridge
10. Trench, back out
11. 45 Balance Beam
12. Balance Beam, 360° turn
13. Rocks
14. Side Pass
15. Balance Beam, side mount 180° turn, back to end, 270° turn, walk off

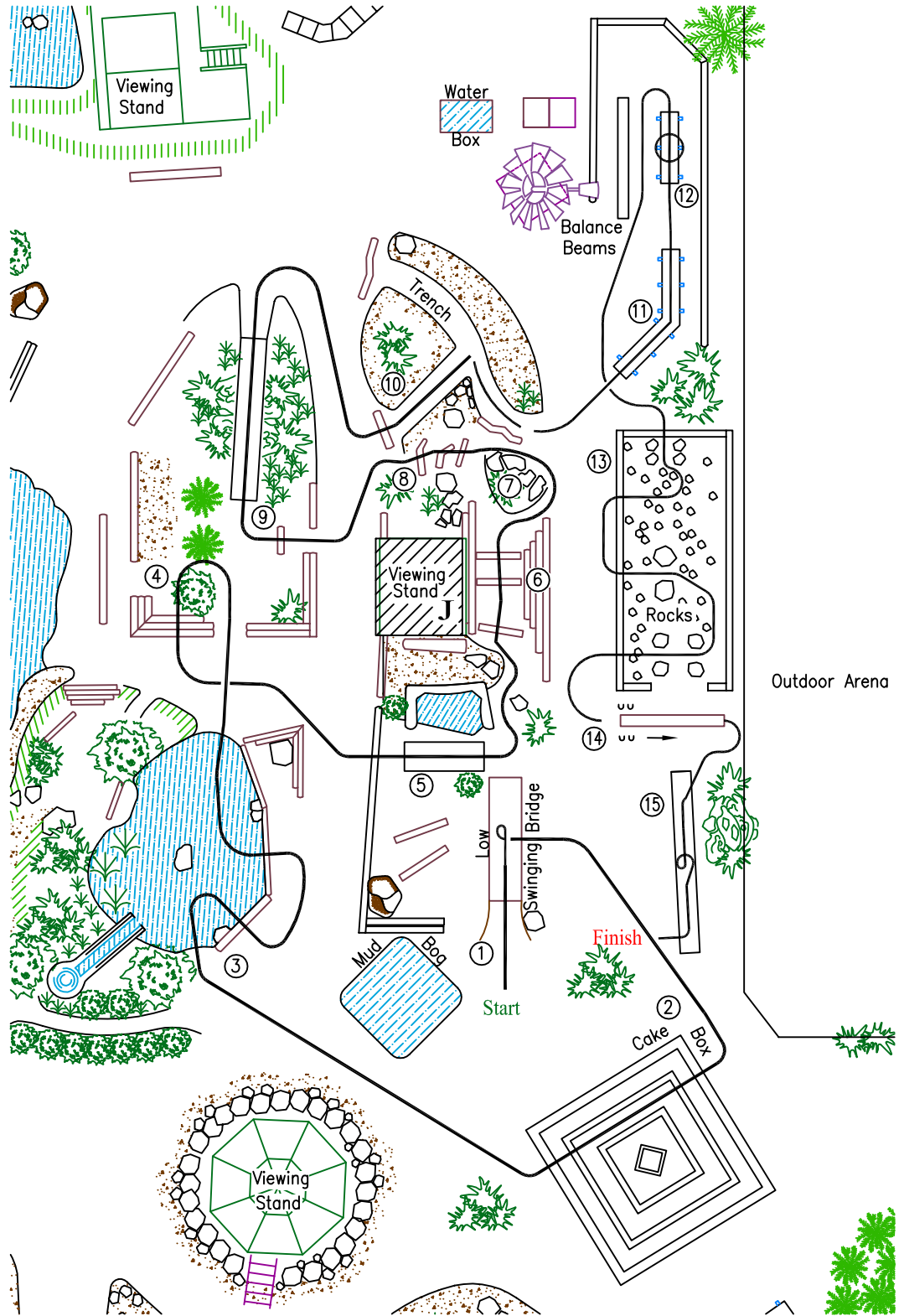

- J** = Judge location
- walk
- - - trot
- . - . cantalope

